

AXIS T92A20 Housing

Protective housing for Axis network cameras.



- > High Power over Ethernet
- > Indoor and outdoor installation
- > Easy installation
- > Aluminum casing
- > IP66-rated protection

AXIS T92A20 Housing protects the Axis network camera in outdoor and adverse indoor conditions.

AXIS T92A20 Housing is tailor-made and carefully tested to comply with Axis network cameras. This stylishly designed housing has a side opening and pre-installed High Power over Ethernet splitter for quick and easy installation. The pre-installed High Power over Ethernet splitter provides power both for the camera and for heating the housing, eliminating the need for additional power cables.

Made of die-cast aluminum, the AXIS T92A20 Housing offers an IP66-rated protection against dust and heavy rain.

The included sunshield, with its integrated edge-protector, offers good thermal insulation, enabling the Axis network camera to operate in temperatures ranging from -20°C up to 50°C (-4°F to 122°F).

The housing comes with a wall bracket with ball joint and internal cable channel. Various accessories are also available.

Supported cameras are AXIS 211W, AXIS 221, AXIS Q1755, AXIS P1311, AXIS P1343, AXIS P1344, AXIS P1346 and AXIS P1347 Network Cameras.



Technical specifications – AXIS T92A20 Housing

General	
Supported cameras	AXIS 211W*, AXIS 221, AXIS Q1755, AXIS P1311, AXIS P1343, AXIS P1344, AXIS P1346 and AXIS P1347 Network Cameras <i>*external antenna required</i>
Casing	Die-cast aluminum Sunshield in ABS Color: White grey RAL9002 3 removable cable glands (2xPG9 and 1xPG11)
Power	AXIS T8123 High PoE 30 W Midspan 1-port
Environment	Indoor/outdoor
Operating conditions	-20°C to + 50°C (-4°F to 122°F)
Protection rating	IP66
Approvals	CE: EN 60950, EN 61000-6-3, EN 50130-4
Weight	3.0 kg (6.6 lb.) incl. sunshield
Included accessories	Sunshield, heater and thermostat, installation kit for camera, Installation Guide, AXIS T8123 High PoE 30 W Midspan 1-port, wall bracket

More information and a configuration tool is available at www.axis.com/accessories

Wall bracket (included)

Ball joint and internal cable channel



Wall bracket accessories

Adapter plate

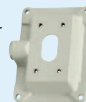

Pole adapter



Corner mount



Other accessories

Waterproof junction box



Axis Power over Ethernet Midspan

Dimensions mm (inch)

